



StockPlus™ Doors and Frames Feature List

**All manufacturers 'hinge and lock locations.
Galvannealed on all surfaces inside and outside.
Same Door Components quality as custom products.**

Stock Honeycomb and Polystyrene Doors (visible seamed edge)

18 Gauge, A60 galvannealed baked-on primer. Made with high density honeycomb core, both edges beveled. Prep. for 3 ea. 4 1/2" X .134 mortise hinges (field modification allows for .180 heavyweight hinges). Integral closer reinforcement. Honeycomb and polystyrene doors can be rated up to 3 hours.

| | 161 x 2 3/4" b.s. | 86 Edge | Rim Panic Reinf.'g | ASA x FB Prep |
|--------------------|-------------------|---------|--------------------|---------------|
| 2-6 x 6-8 x 1 3/4" | | | | |
| 2-8 x 6-8 x 1 3/4" | | | | |
| 3-0 x 6-8 x 1 3/4" | | | | |
| 3-6 x 6-8 x 1 3/4" | | | | |
| 4-0 x 6-8 x 1 3/4" | | | | |
| 2-6 x 7-0 x 1 3/4" | | | | |
| 2-8 x 7-0 x 1 3/4" | | | | |
| 3-0 x 7-0 x 1 3/4" | | | | |
| 3-6 x 7-0 x 1 3/4" | | | | |
| 4-0 x 7-0 x 1 3/4" | | | | |
| 2-6 x 8-0 x 1 3/4" | | | | |
| 2-8 x 8-0 x 1 3/4" | | | | |
| 3-0 x 8-0 x 1 3/4" | | | | |
| 3-6 x 8-0 x 1 3/4" | | | | |
| 4-0 x 8-0 x 1 3/4" | | | | |

Call your Door Components sales rep for current pricing or email sales@doorcomponents.com

| | |
|---|--|
| Fire Label Dead Lock Mortise / Sectional Trim Panic Face prep (Mortise & Rim) Flat Bar Astragal (Loose) Flat Bar Astragal (Welded) | Vision Lite Cutout Only Vision Lite Cutout and Channeled Only Louver Cutout Only Louver Cutout and Channeled Only Flush Top Cap Installed Polystyrene door (additional) |
|---|--|

Terms: All prices are FOB Fontana. No minimum order required. Order by 10 a.m., pick up at 4 p.m. at plant (business days). Next business day delivery in five California counties (Riverside, Orange, Los Angeles, San Diego, San Bernardino); five-county delivery charge is additional 15% of entire order. Delivery available to other locations, with pricing quoted per order. Prices and dimensions are subject to change without notice; please confirm at time of purchase. Add taxes if applicable. See your Door Components sales rep. for quantity discounts.

DOOR COMPONENTS

StockPlus™ Frames Feature List

Stock KD Drywall Frames with Anchors - 2" Face / Equal Rabbet / 1/2" Drywall Returns

16 Gauge, A60 galvanized baked-on primer. All drywall frames can be rated up to 90 minute. 'S' label. Prep. for 3 each 4 1/2" X .134 mortise hinges (field modification allows for .180 heavyweight hinges). ASA Strike prep. (4 7/8") or rim panic reinforcement.

| | 5-7/8" | 6-1/4" | 8-1/4" |
|---------------------------------|--------|--------|--------|
| 2-6 x 6-8 / 2-6 x 7-0 | | | |
| 2-8 x 6-8 / 2-8 x 7-0 | | | |
| 3-0 x 6-8 / 3-0 x 7-0 | | | |
| 3-6 x 6-8 / 3-6 x 7-0 | | | |
| 4-0 x 6-8 / 4-0 x 7-0 | | | |
| 3-0 x 8-0 / 3-6 x 8-0 | | | |
| 4-0 x 8-0 | | | |
| 4-0 x 6-8 / 4-0 x 7-0 PAIR FRM. | | | |
| 4-0 x 8-0 PAIR FRM. | | | |
| 5-0 x 6-8 / 5-0 x 7-0 PAIR FRM. | | | |
| 5-0 x 8-0 PAIR FRM. | | | |
| 6-0 x 6-8 / 6-0 x 7-0 PAIR FRM. | | | |
| 6-0 x 8-0 PAIR FRM. | | | |

Call your Door Components sales rep for current pricing or email sales@doorcomponents.com

Includes Silencer Holes

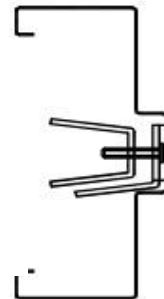

| | |
|------------|------------------|
| Fire Label | Dead Lock Strike |
|------------|------------------|

Stock Masonry Frames with Anchors - 2" Face / Equal Rabbet

16 Gauge, A60 galvanized baked-on primer. Frames can be rated up to 3 hours. 'S' label. Prep. for 3 ea. 4 1/2" X .134 mortise hinges (field modification allows for .180 heavyweight hinges). ASA Strike prep. (4 7/8") or rim panic reinforcement.

| | 5-3/4" 7/16" returns | 6-1/4" 1/2" returns | 7-3/4" 1/2" returns | 8-1/4" 1/2" returns |
|---------------------------------|-------------------------|------------------------|------------------------|------------------------|
| 2-6 x 6-8 / 2-6 x 7-0 | | | | |
| 2-8 x 6-8 / 2-8 x 7-0 | | | | |
| 2-10 x 6-8 / 2-10 x 7-0 | | | | |
| 3-0 x 6-8 / 3-0 x 7-0 | | | | |
| 3-6 x 6-8 / 3-6 x 7-0 | | | | |
| 4-0 x 6-8 / 4-0 x 7-0 | | | | |
| 3-0 x 8-0 / 3-6 x 8-0 | | | | |
| 4-0 x 8-0 | | | | |
| 4-0 x 6-8 / 4-0 x 7-0 PAIR FRM. | | | | |
| 4-0 x 8-0 PAIR FRM. | | | | |
| 5-0 x 6-8 / 5-0 x 7-0 PAIR FRM. | | | | |
| 5-0 x 8-0 PAIR FRM. | | | | |
| 6-0 x 6-8 / 6-0 x 7-0 PAIR FRM. | | | | |
| 6-0 x 8-0 PAIR FRM. | | | | |
| 7-0 x 6-8 / 7-0 x 7-0 PAIR FRM. | | | | |
| 7-0 x 8-0 PAIR FRM. | | | | |
| 8-0 x 6-8 / 8-0 x 7-0 PAIR FRM. | | | | |
| 8-0 x 8-0 PAIR FRM. | | | | |

Call your Door Components sales rep for current pricing or email sales@doorcomponents.com

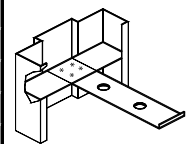

Includes Silencer Holes

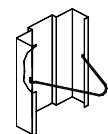

| | | |
|---|--------------------------------|-----------------------------|
| Punch & Dimple (no bolts) XB5 Bolts (each) | Dead Lock Strike Fire Label | Face Weld Welded Anchors |
|---|--------------------------------|-----------------------------|

Terms: All prices are FOB Fontana. No minimum order required. Order by 10 a.m., pick up at 4 p.m. at plant (business days). Next business day delivery in five California counties (Riverside, Orange, Los Angeles, San Diego, San Bernardino); five-county delivery charge is additional 15% of entire order. Delivery available to other locations, with pricing quoted per order. Prices and dimensions are subject to change without notice; please confirm at time of purchase. Add taxes if applicable. See your sales rep. for quantity discounts.